

GENERAL NOTES:
 ALL EXISTING FLOORS ARE ANTICIPATED TO BE DEMOLISHED AND REPACED
 GRAY WALLS ARE EXISTING WALLS
 ALL WALLS ARE PAINTED GYPBD, EXISTING WALL ARE EITHER FURRED OR HAVE ADHERED GYPBD

FINISHES
 CEILING: EXISTING
 WALLS: PTD GYP BD
 FLOORING: EPOXY FLOORS W/ ALTERNATE LOGO EMBEDMENT
 LIGHTING SURFACE MOUNTED THIN LED'S
 FIXTURES EQUAL TO OTHERS IN SCHOOL
 LOCKERS: SEE ATTACHED

LOCKER ROOM RENOVATION

RICHARDTON-TAYLOR HIGH SCHOOL ADDITION & RENOVATION

320 RAIDER ROAD
 RICHARDTON, ND 58852

05/25/218 PROJ # 16-11

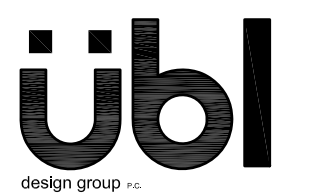

THE PERFECT SYNERGY OF FORM & FUNCTION

For each industry, Tufftec Lockers® have a solution for every place and purpose. Select from a multitude of styles, configurations and interchangeable options to create customized lockers that meet the most demanding specifications and stand up to the most challenging environments.

- Solid, classic construction
- Good looks
- Versatile configurations
- Versatile storage solutions

FEATURES & BENEFITS

- Resistant to bacteria, mold and mildew
- Impact and dent resistant
- Will never rust, corrode or delaminate
- Never needs painting
- Scratch resistant
- Impermeable to moisture
- Power washable and steam cleanable
- Common chemical resistance
- Graffiti resistance – resists pencil, pen, paint, stickers and most markers
- Provides years of everyday low maintenance

LASTING STYLE

Tufftec Lockers® – where solid plastic construction meets good looks. We've combined the two to provide the perfect synergy of form and function. Engineered for strength and durability, HDPE withstands the harshest daily use and is virtually maintenance free. Formulated from a homogenous color-throughout compound, Tufftec Lockers® are the most durable, cost-effective and aesthetically pleasing products in the industry - and they are backed by our 25-year warranty.

A SOLID ADVANTAGE

A 100 lb. impact test conducted following ASTM standards showed that Tufftec Lockers® had 59 times greater resistance to impacts when compared to metal lockers.

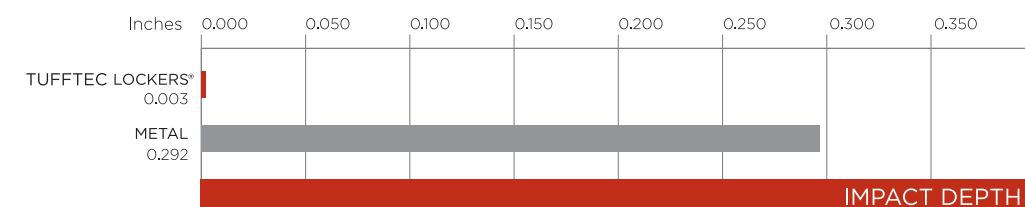

BATHROOM PARTITIONS
LOCKERS
LOCKER ROOM BENCHES
SHOWER CUBICLES
DRESSING COMPARTMENTS
VANITIES

WE DON'T JUST TALK TOUGH.
WE BACK IT UP.

Proudly made in the USA, Scranton Products' brands provide industry-leading protection. Because Scranton Products is so confident that our solid plastic lockers will stand the test of time, they're backed with a full 25-year warranty covering breakage, corrosion and delamination under normal conditions.

Call 800.445.5148 for the Scranton Products sales representative in your area, or visit scrantonproducts.com



Scranton Products
801 E. Corey Street
Scranton, PA 18505
800.445.5148
Fax: 800.551.6993
info@scrantonproducts.com
www.scrantonproducts.com





MANY APPLICATIONS; MANY OPTIONS.

DESIGN OPTIONS

Designed to be customizable, Tufftec Lockers® offer a broad range of styles, configurations and interchangeable options, allowing you to create customized storage to meet your most demanding specifications. Engineered for strength and durability, Tufftec Lockers® are designed to withstand the harshest daily use and provide years of maintenance-free storage solutions. From healthcare, to industrial, to recreation and athletics, Tufftec Lockers® provide highly versatile, tough, aesthetically pleasing solutions for all your locker applications.

SPECIALTY STYLE OPTIONS

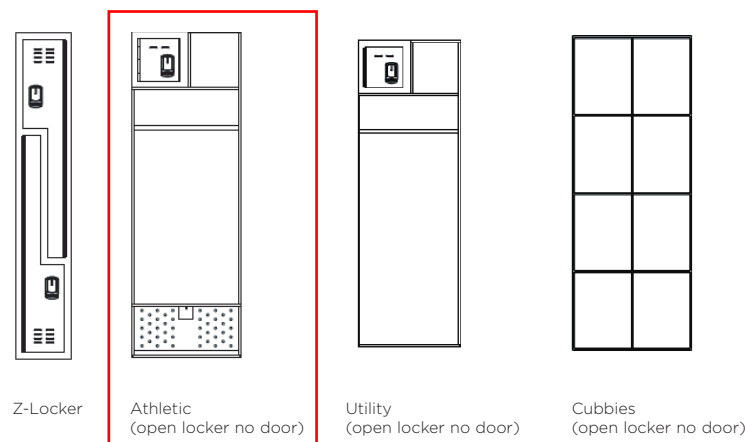

VENTING OPTIONS

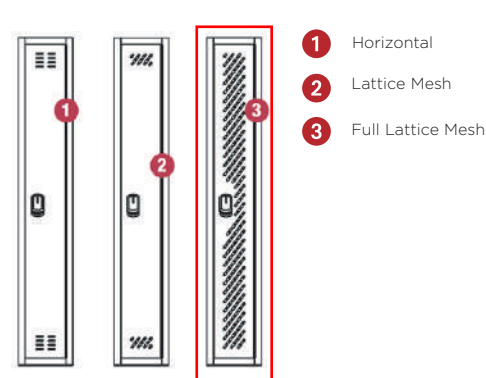

HINGE

Heavy duty extruded aluminum with corrosion-free stainless steel pin for years of superior corrosion-free performance. Available in silver and black.

TOPS

Tops are fabricated to be shipped unattached and installed in the field.

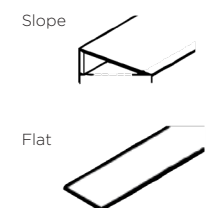

LOCKER BASE

4" high black base. Bases are assembled in the field.

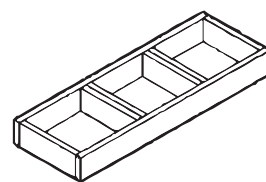

HANDLE

Ergonomic handle, designed to meet ADA code compliance.



ADA COMPLIANCE

ADA compliant conversion kits available with ADA plaques, adjustable shelves and clips.



ENGRAVING

Custom engraving of team logos and other symbols available in one-color or two-color options.



FILLERS

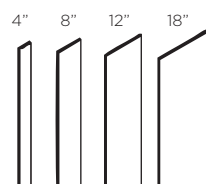

LOCK OPTIONS



PLASTIC BENCHES

1 1/2" thick plastic benches to match locker color selections with aluminum pedestals.



HOOKS

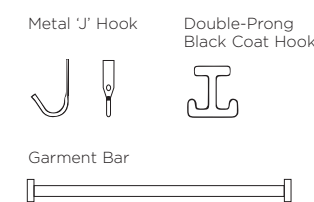

LOCKER OPTIONS

Tufftec® has a style and configuration for every place and purpose.

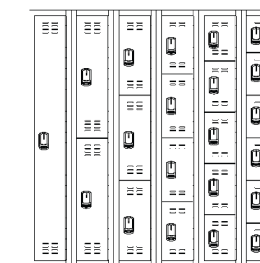

(1-6 tier)

ONE TIER LOCKERS

W"	D"	H"
12	12	36, 48, 60, 72
12	15	36, 48, 60, 72
12	18	36, 48, 60, 72
15	12	36, 48, 60, 72
15	15	36, 48, 60, 72
15	18	36, 48, 60, 72
18	12	36, 48, 60, 72
18	15	36, 48, 60, 72
18	18	36, 48, 60, 72

TWO TIER LOCKERS

W"	D"	H"
12	12	48, 60, 72
12	15	48, 60, 72
12	18	48, 60, 72
15	12	48, 60, 72
15	15	48, 60, 72
15	18	48, 60, 72
18	12	48, 60, 72
18	15	48, 60, 72
18	18	48, 60, 72

THREE TIER LOCKERS

W"	D"	H"
12	12	60, 72
12	15	60, 72
12	18	60, 72
15	12	60, 72
15	15	60, 72
15	18	60, 72
18	12	60, 72
18	15	60, 72
18	18	60, 72

FOUR TIER LOCKERS

W"	D"	H"
12	12	48, 60, 72
12	15	48, 60, 72
12	18	48, 60, 72
15	12	48, 60, 72
15	15	48, 60, 72
15	18	48, 60, 72
18	12	48, 60, 72
18	15	48, 60, 72
18	18	48, 60, 72

FIVE TIER LOCKERS

W"	D"	H"
12	12	60, 72
12	15	60, 72
12	18	60, 72
15	12	60, 72
15	15	60, 72
15	18	60, 72
18	12	60, 72
18	15	60, 72
18	18	60, 72

SIX TIER LOCKERS

W"	D"	H"
12	12	72
12	15	72
12	18	72
15	12	72
15	15	72
15	18	72
18	12	72
18	15	72
18	18	72

COLOR COLLECTION

Tufftec Lockers® are available in a variety of popular designer colors to complement virtually any style or décor.

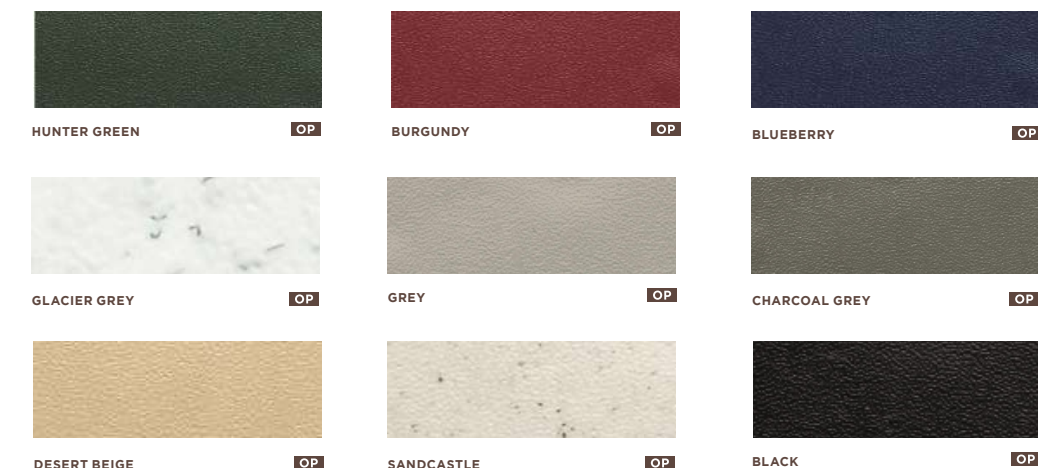

* Color matching is limited by printing process. Actual samples available and are recommended.
* Prior to color selections, special orders require extended lead time. Minimum order requirements of 250 frames apply with additional upcharges.

GIRLS LOCKER CONCEPT



BOYS LOCKERS CONCEPT

